

SBS

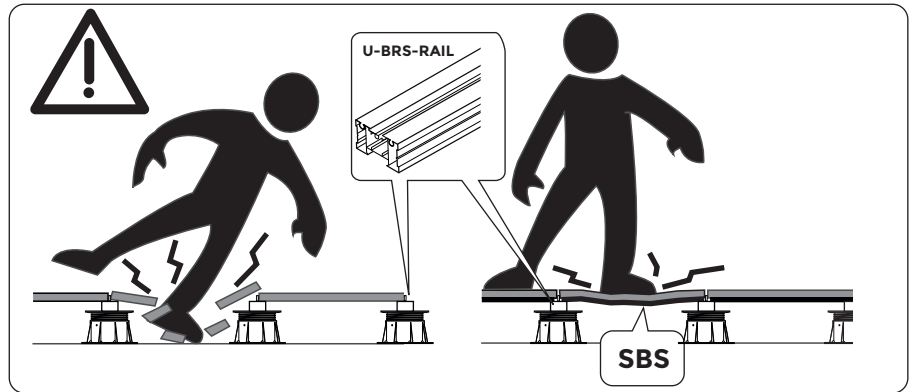

Apply within  
9 months from  
date of  
manufacturing



Do not install  
below 0°C

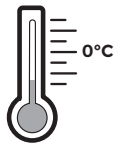

Storage

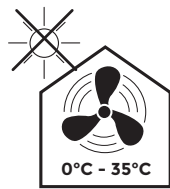

Tools

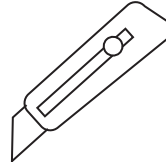

Cutter

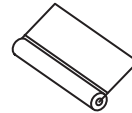

Manual pressure roller

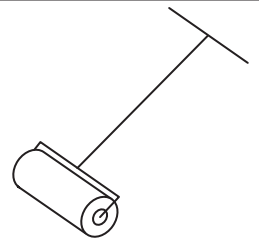

T-Handle pressure roller

### 1 Create a template ( 5mm less at each side of the tile)

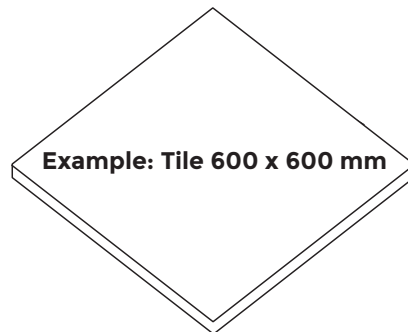
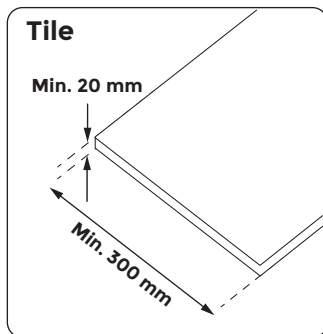

Example: Tile 600 x 600 mm

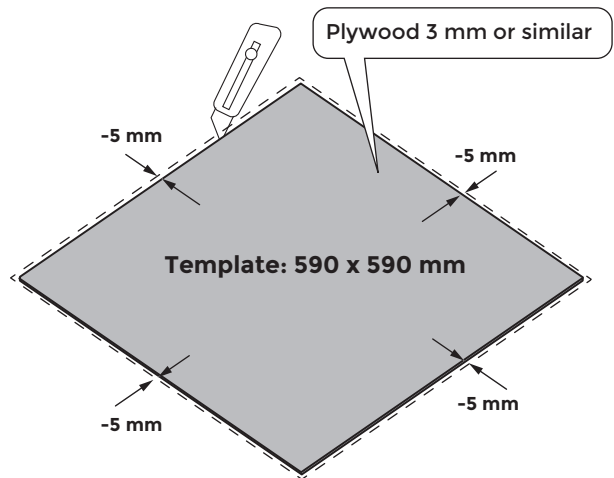

### 2 Spread the SBS out on a flat surface

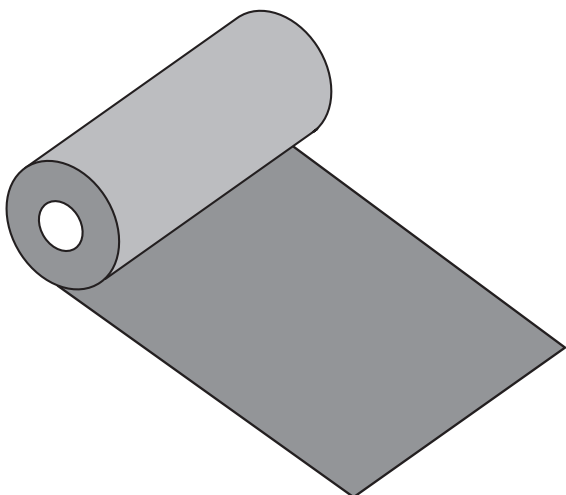

### 3

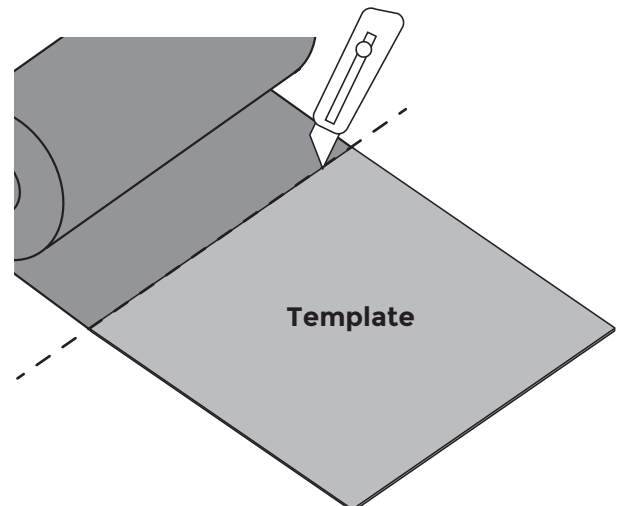

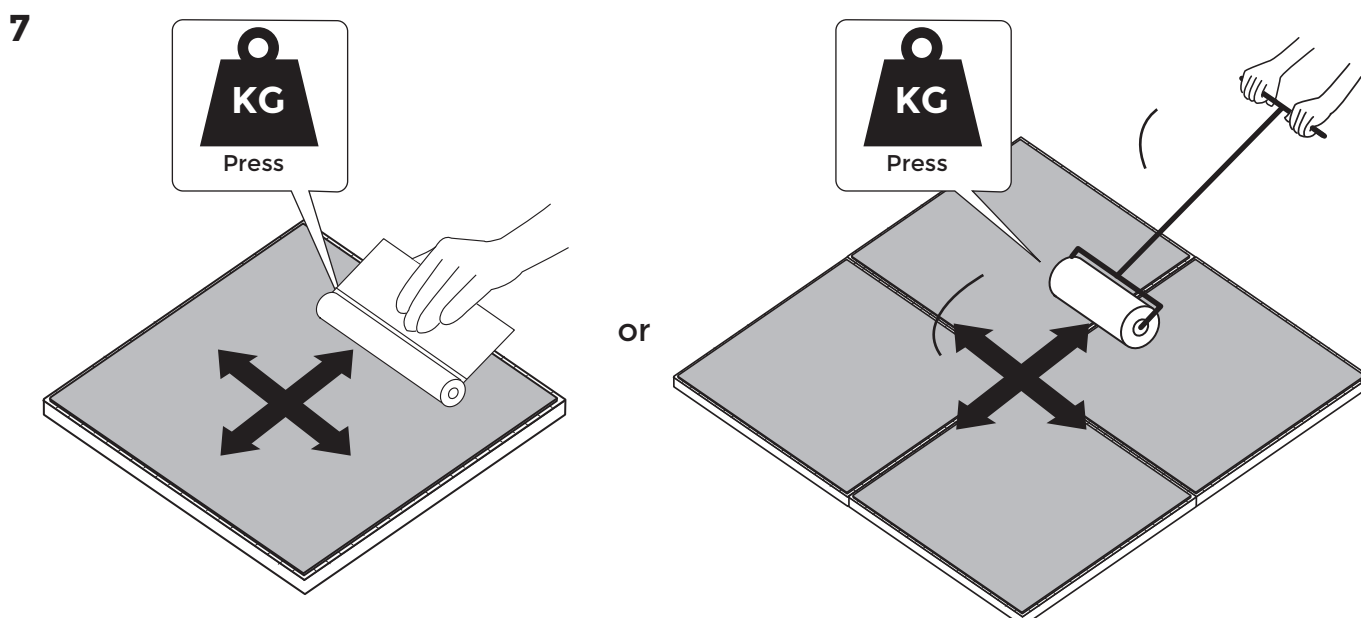
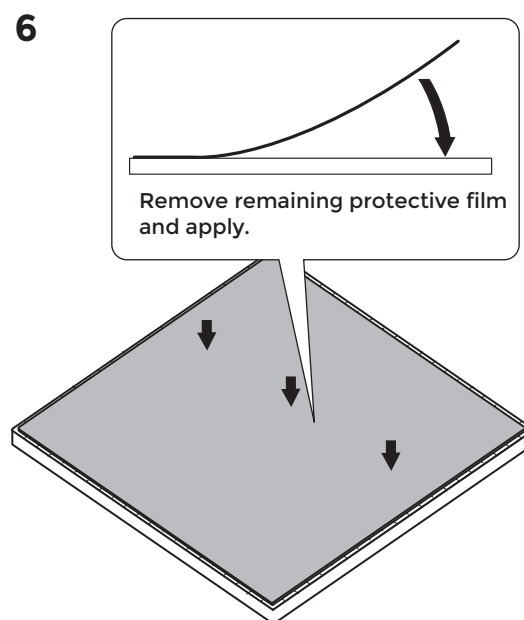
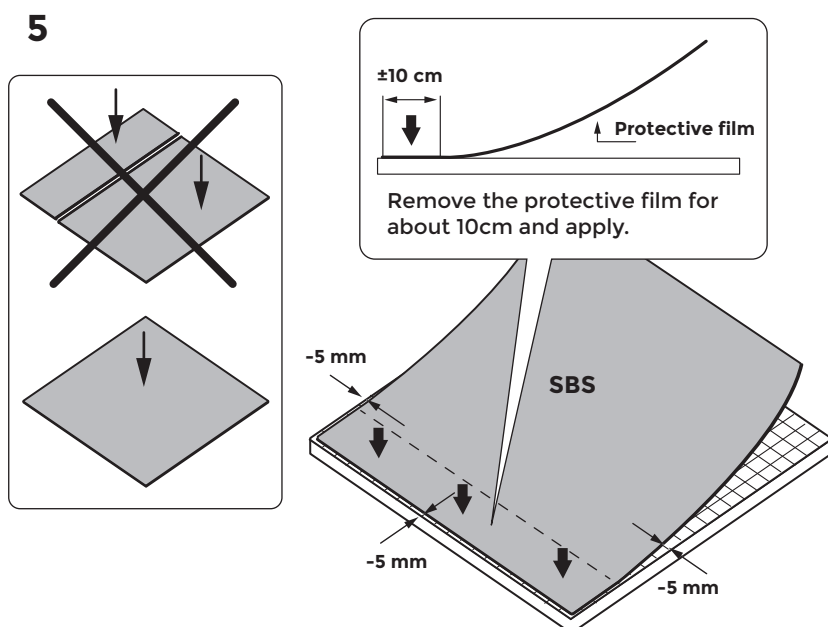
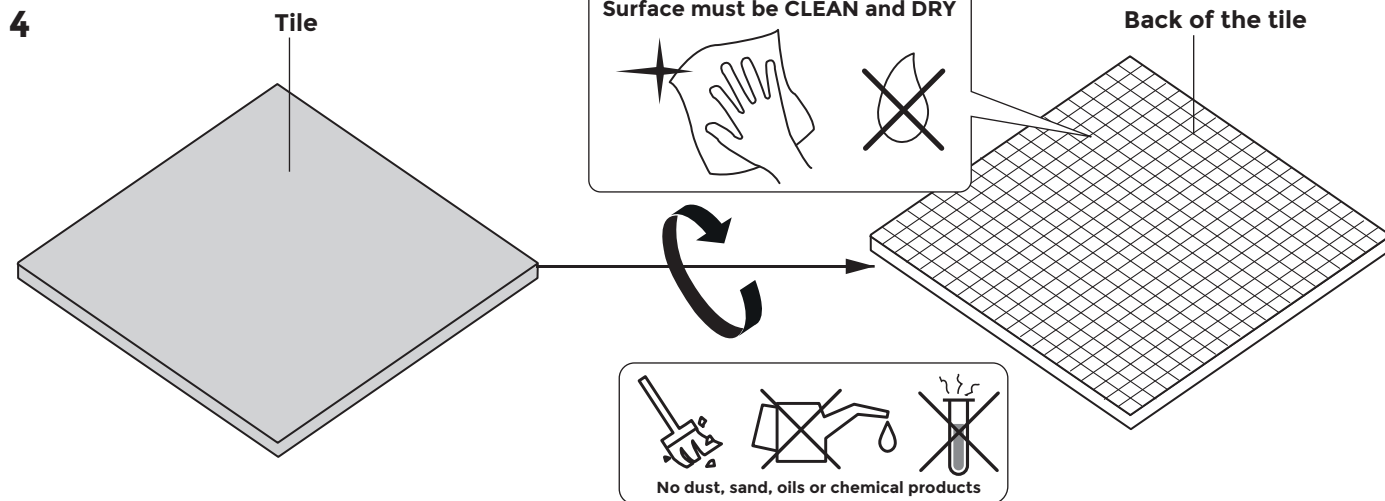

8

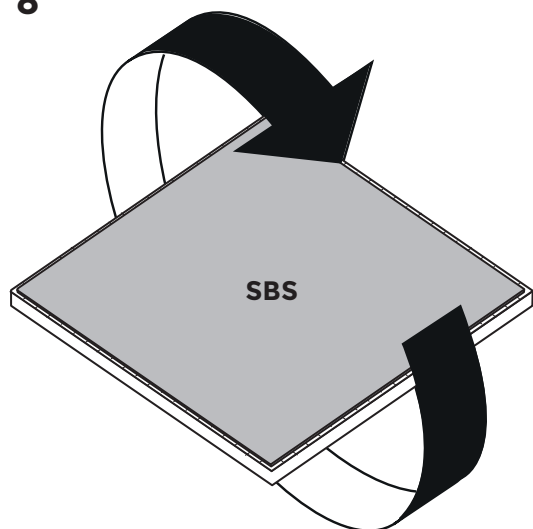

9

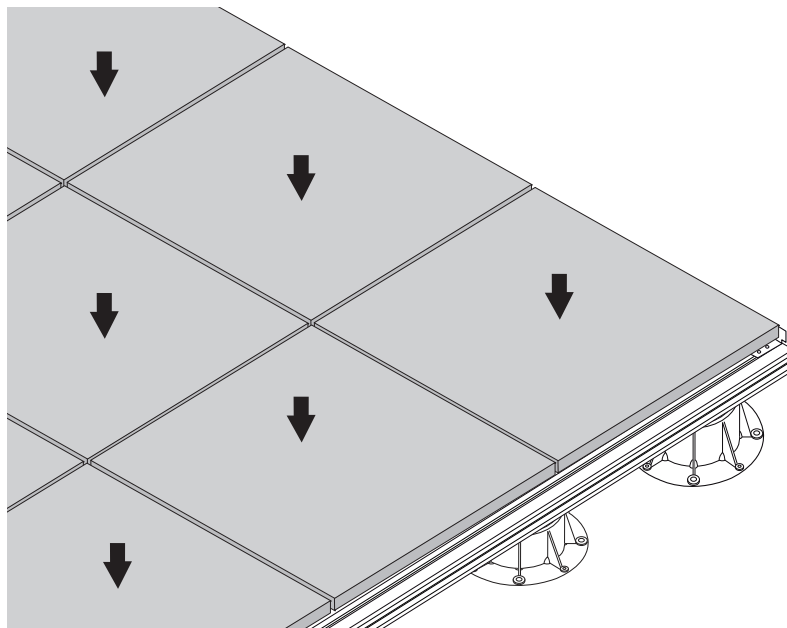

### Stacking

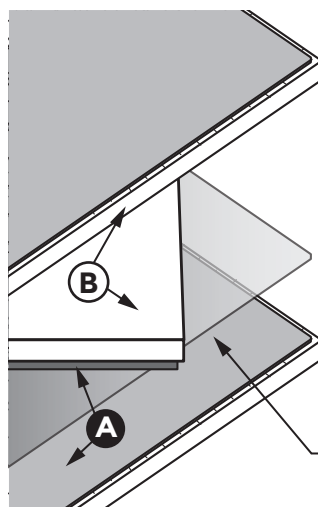

**B** Top sides of tiles

**A** SBS facing each other  
Always insert a plastic film or sheet

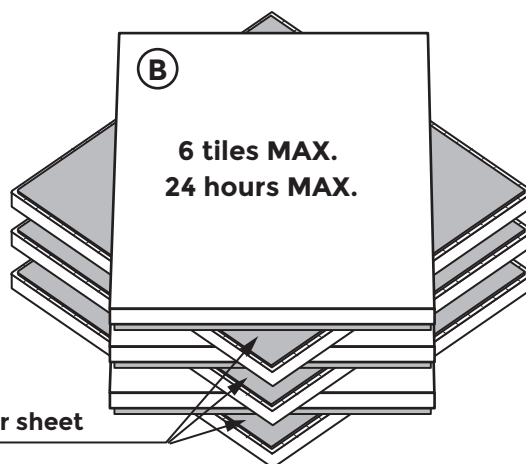

### Close off the area awaiting replacement tile

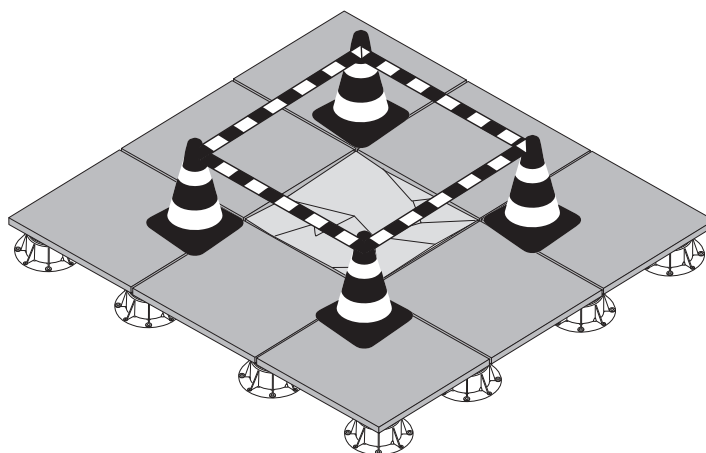
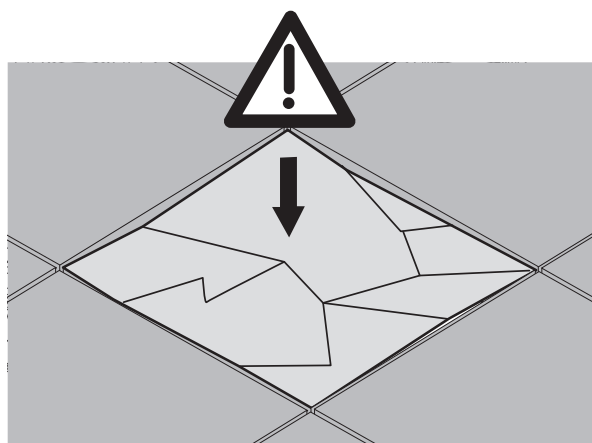



Buzon pedestals and accessories are designed to support external raised floors and terraces, for pedestrian traffic only, and are not designed to support or to be subjected to moving and/or vibrating machinery and equipment, including maintenance and cleaning vehicles, automobiles and other similar vehicles or equipment.

BUZON will not be liable for any damage as result of applications not meeting these requirements, and if the load supported by the pedestals does not comply with the manufacturer's specifications, as provided in the TDS (Technical Data Sheet) of each pedestal, and and for any damage that may occur if the pedestals and/or paving stones are not laid in accordance with the manufacturer's instructions or good practice.

Always check with the paver supplier whether the pavers are suited for raised applications on pedestals, can accept the required loading capacity of your terrace application and whether all local requirements are met for this type of application.

Under no circumstances can BUZON be held responsible for any damage that may result from damaged or fractured tiles.